

Obiekt dydaktyczny
przy ul. Szczerbcowej 4

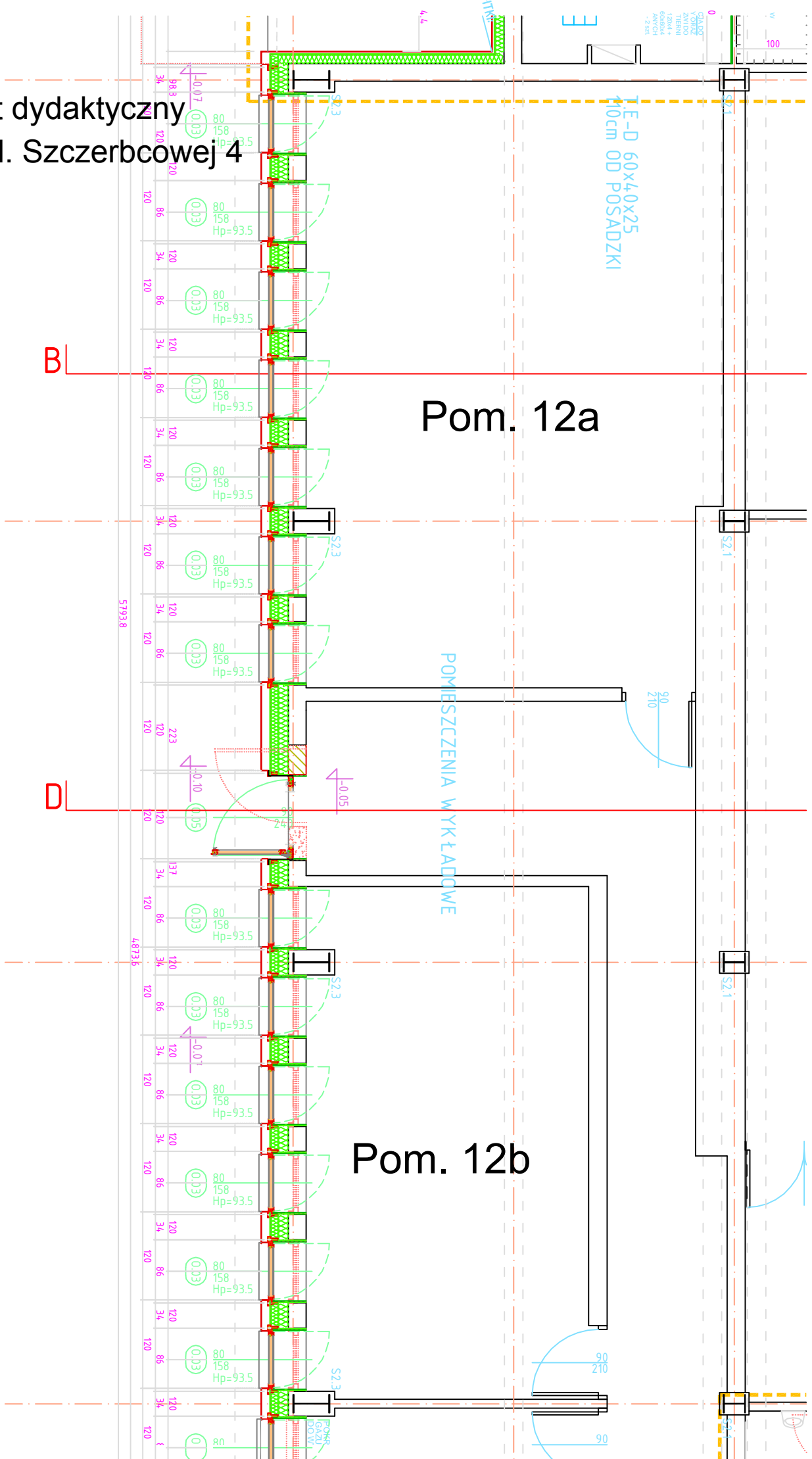

Budynek Pływalni

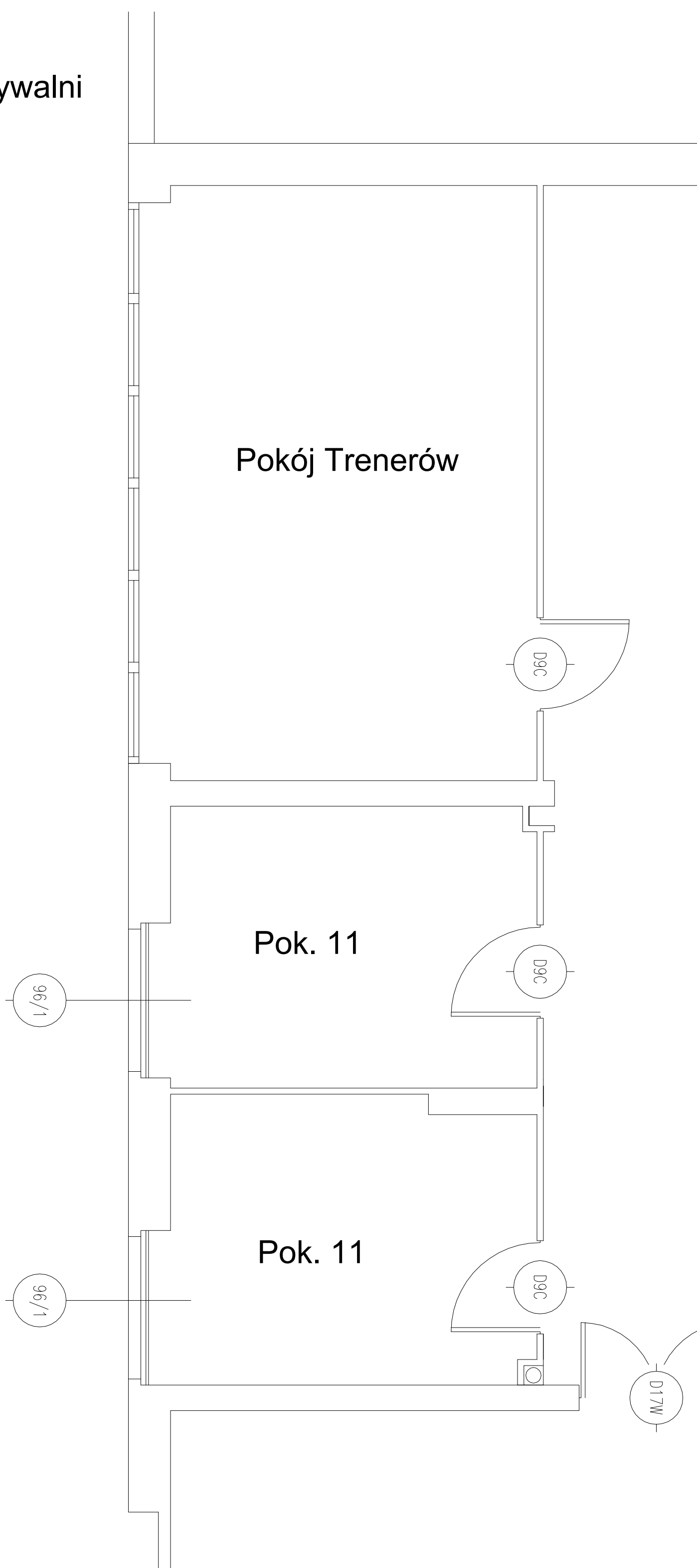

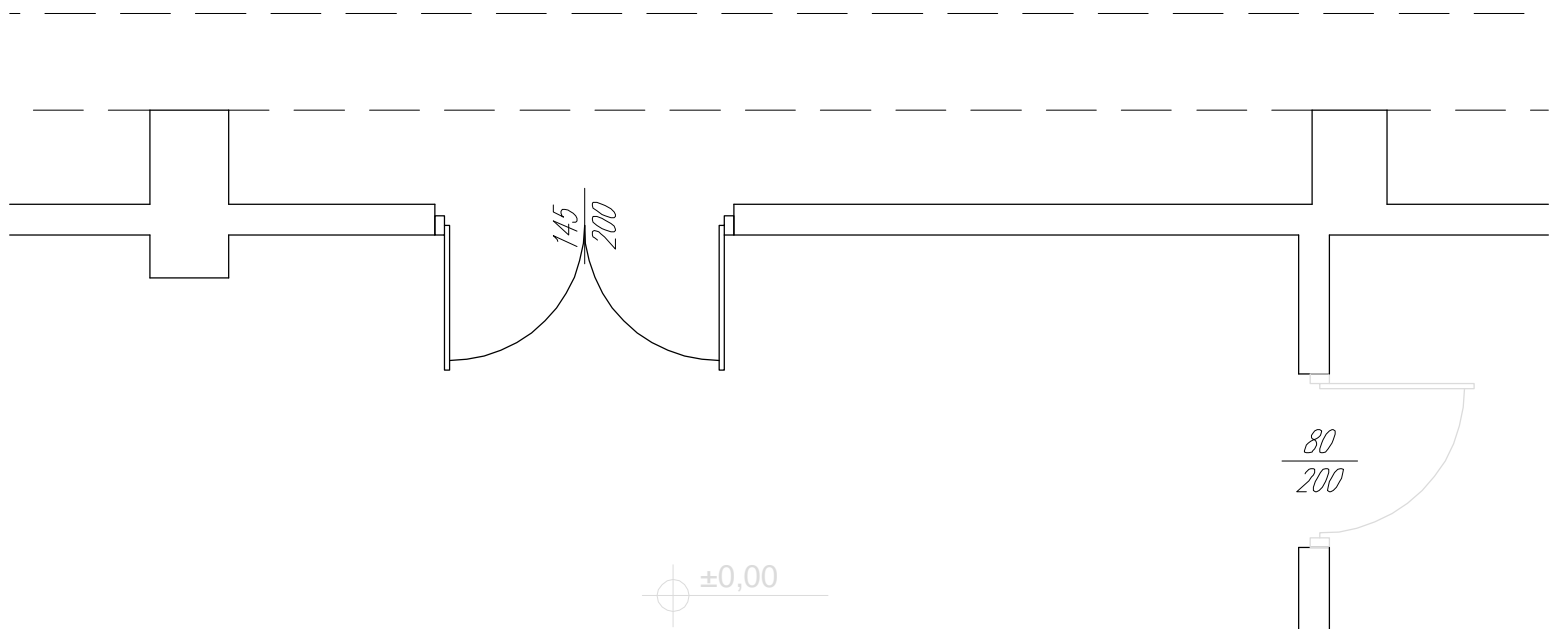

±0,00

60/100



h_{pod} - 27cm

(hp24)260

14

20

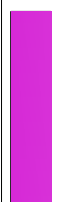

33K/30/200

| | |
|-----|---------|
| 205 | holl |
| 16° | 5 174 W |

33K/30/200



18

950
(hp53)200

987
(hp53)200

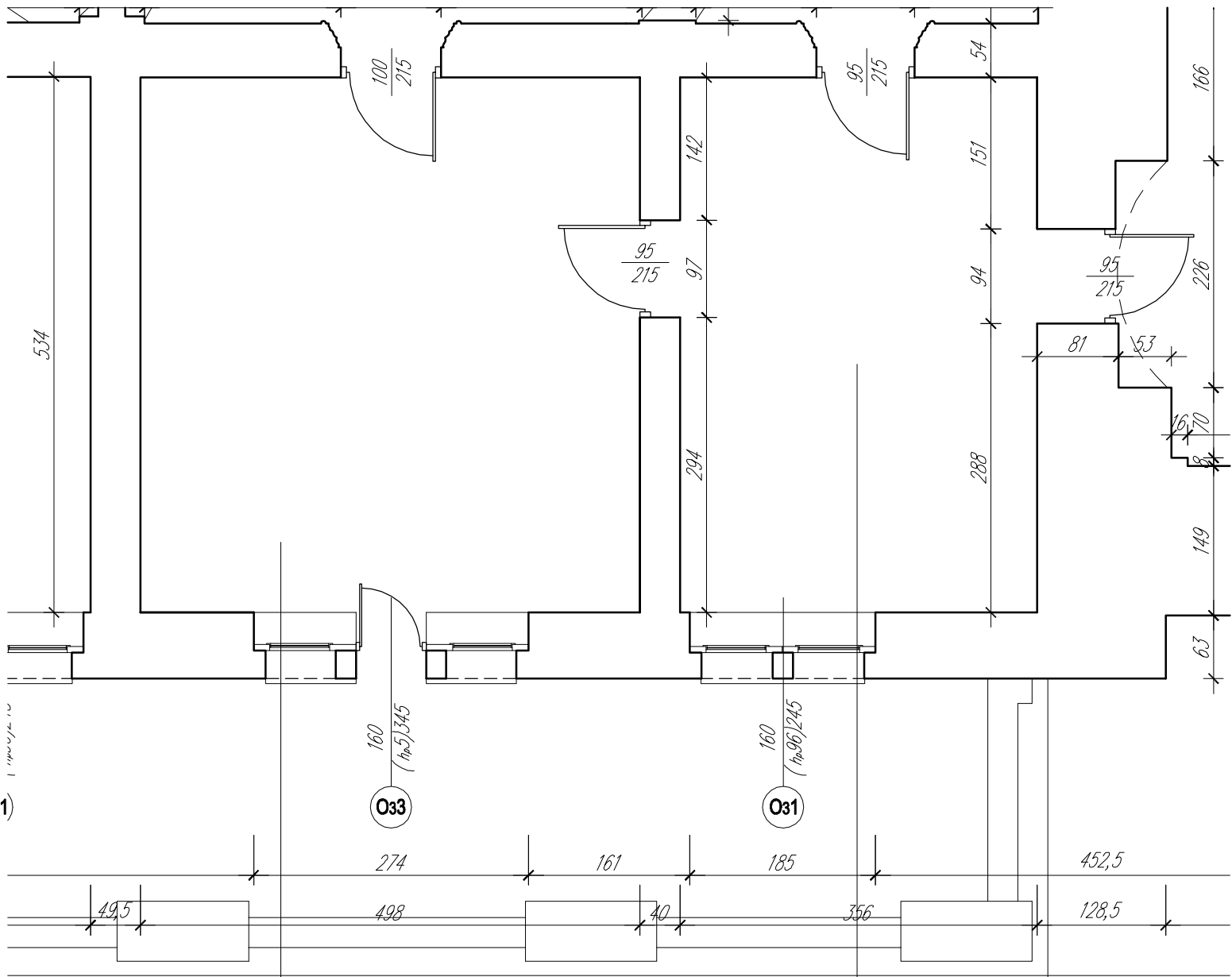

1) | 1100

TA

| | | | |
|--------------------------|----------------------|--------------------------|----------------------|
| 2.9 (113) | LAB. SYM. MANEWRWEGO | 2.11 (114) | LAB. SYM. MANEWRWOWE |
| 26,5m ² | PCV | 19,0m ² | PCV |
| H _{pom} - 4,18m | | H _{pom} - 4,20m | |

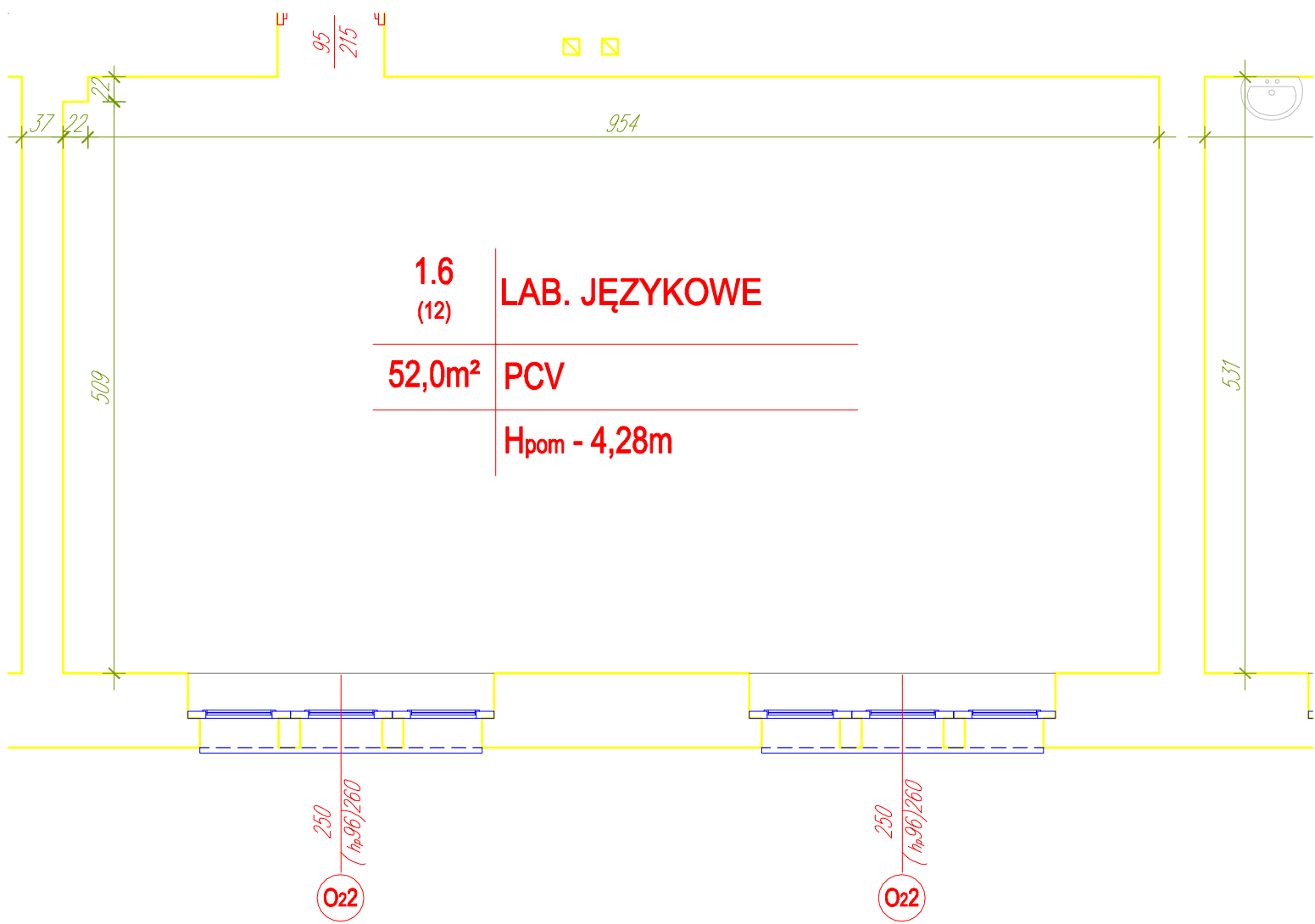

ĘGOWOŚCI

m

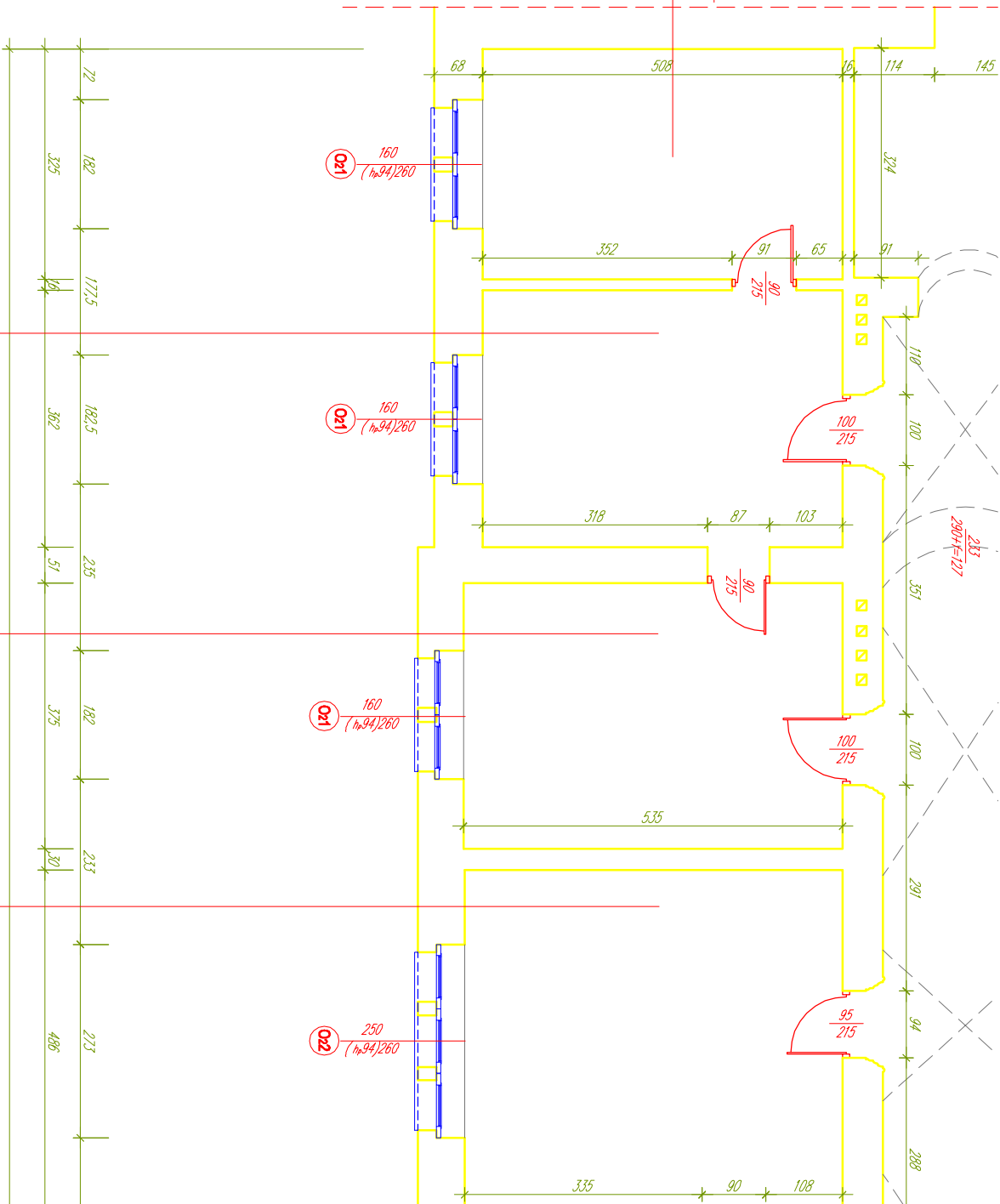

| | | |
|---------------------------|-----|--------------------------|
| 1.2 | (8) | DZIAŁ KSIĘGOWOŚCI |
| 18,3m ² | PCV | |
| H _{poim} - 4,30m | | |

| | | |
|---------------------------|-----|---|
| 1.3 | (9) | UCZELNIANE CENTRUM INFORMACYCZNE |
| 20,0m ² | PCV | |
| H _{poim} - 4,30m | | |

| | | |
|---------------------------|------|---|
| 1.4 | (10) | SEKRETARIAT DZIAŁ SPRAY MORSKICH I PRAKTYK |
| 26,0m ² | PCV | |
| H _{poim} - 4,30m | | |

| | | |
|---------------------------|-----|---|
| 1.3 | (9) | UCZELNIANE CENTRUM INFORMACYCZNE |
| 20,0m ² | PCV | |
| H _{poim} - 4,30m | | |

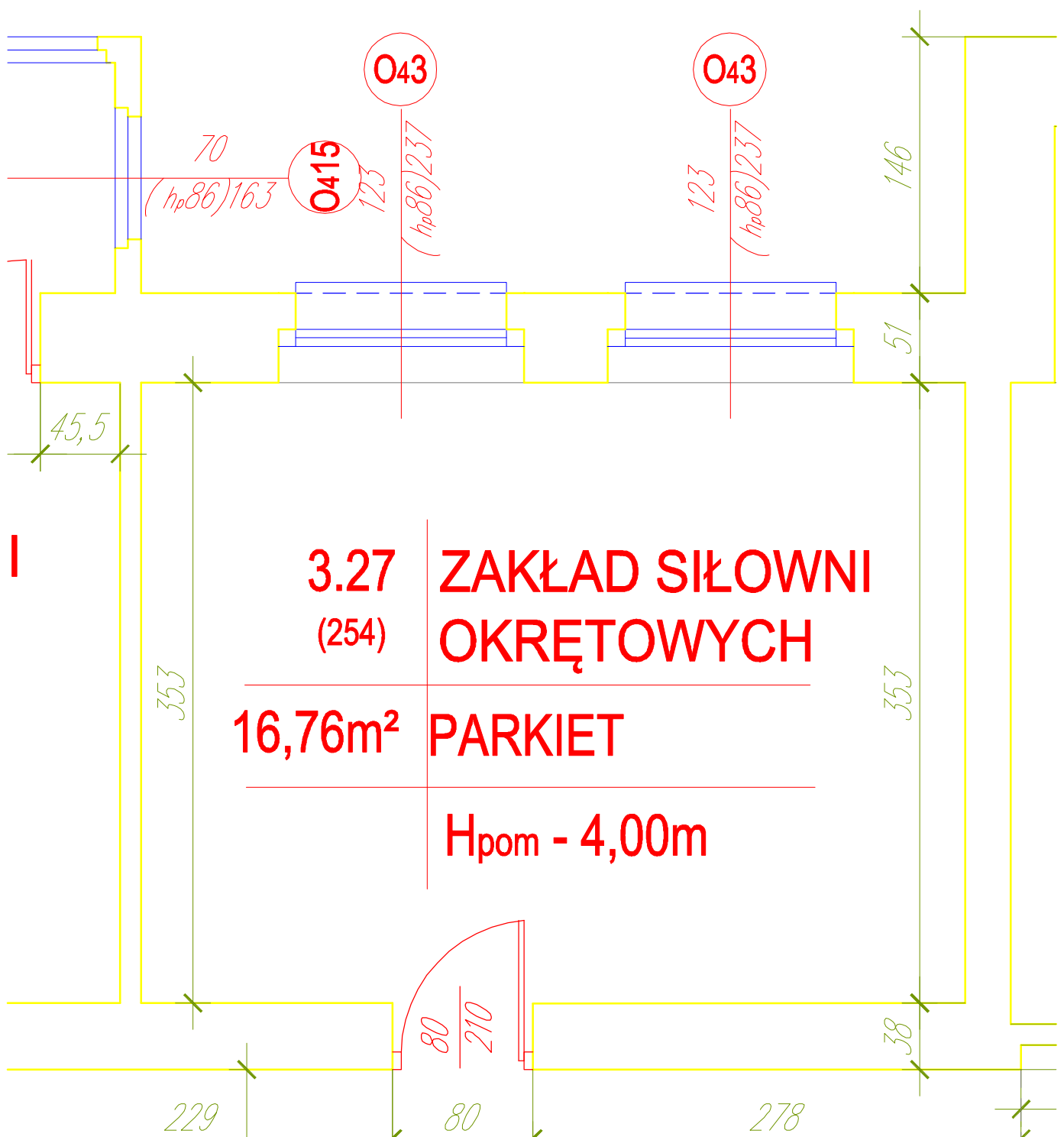
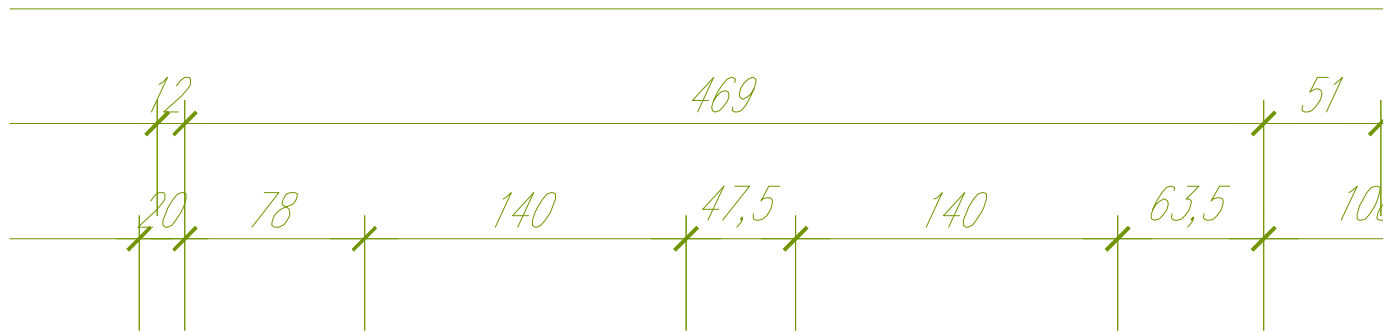

I

**3.27 ZAKŁAD SIŁOWNI
(254) OKRĘTOWYCH**

16,76m² PARKIET

Hpom - 4,00m

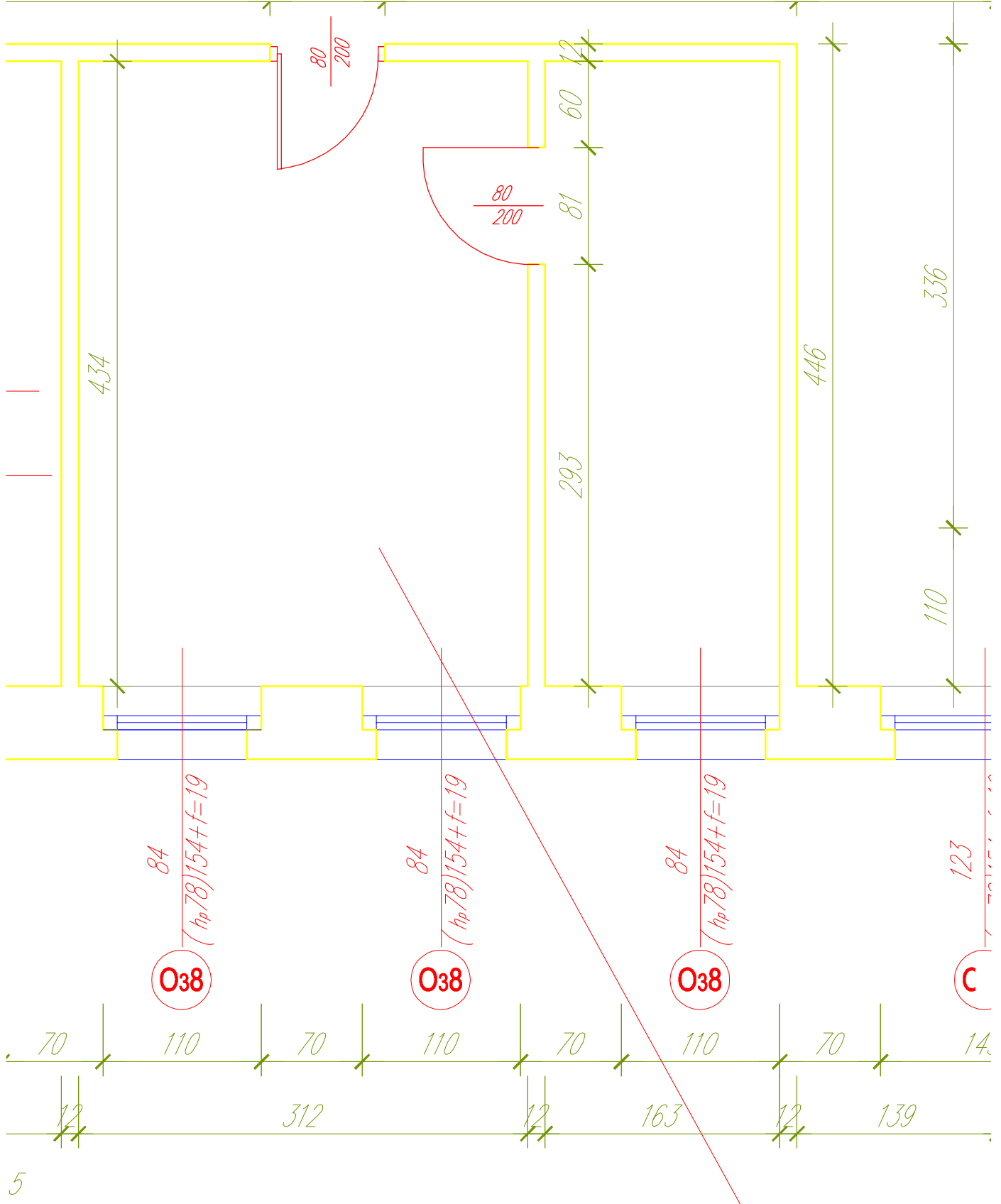

TKA SCHODOWA
KI CERAMICZNE/
JCZNY KAMIEŃ

2.29
 (162)

ZAKŁAD MASZY
URZĄDZEŃ
OKRĘTOWYCH

21,13m²

PARKIET

H_{oom} - 2.79m

2115,5

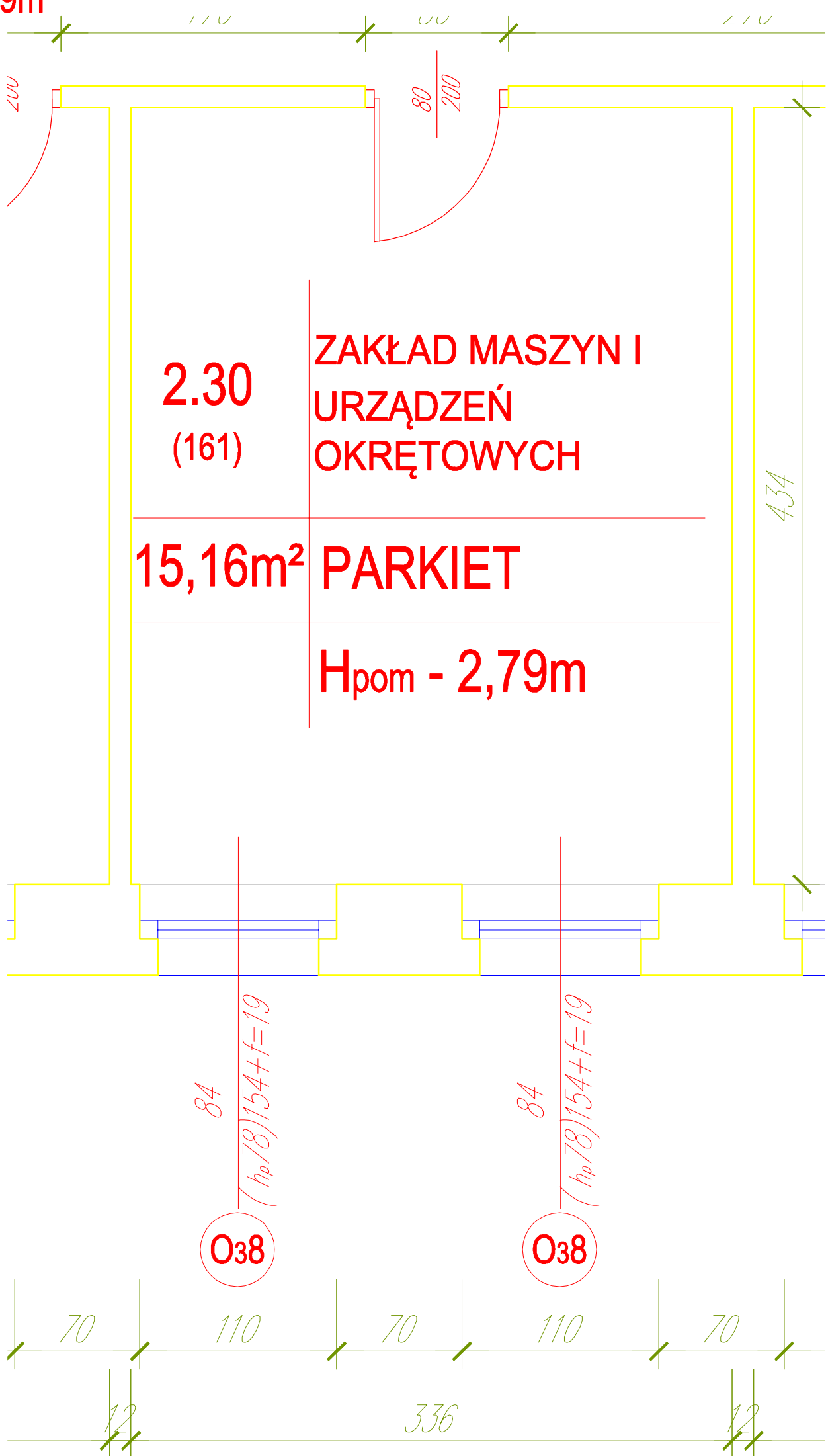

MASZYN I
EŃ
OWYCH

2.27
(157)

ZAKŁAD MASZYN I
URZĄDZEŃ
OKRĘTOWYCH

ET

20,34m² PARKIET

2,79m

H_{pom} - 2,79m

4779

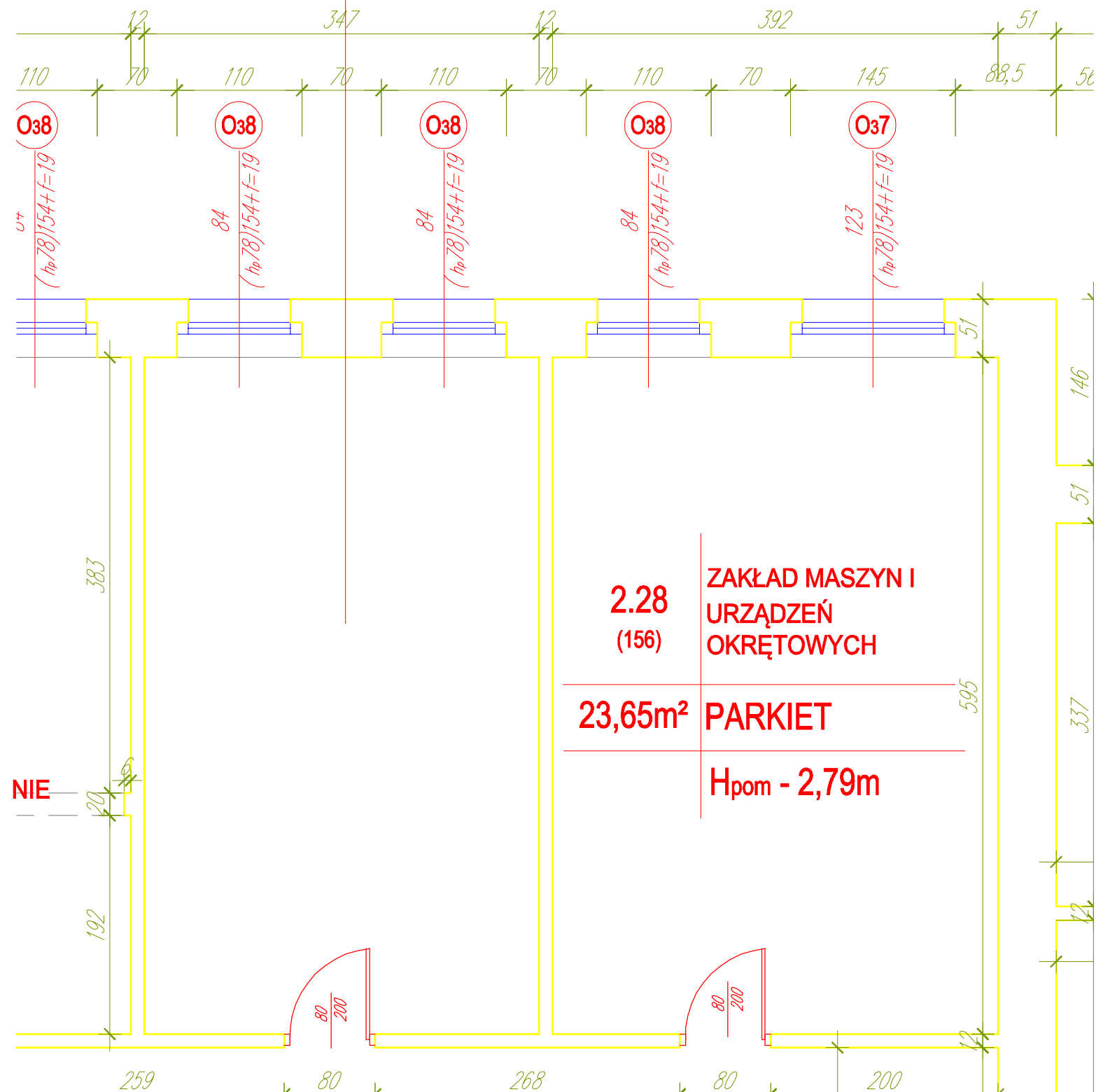

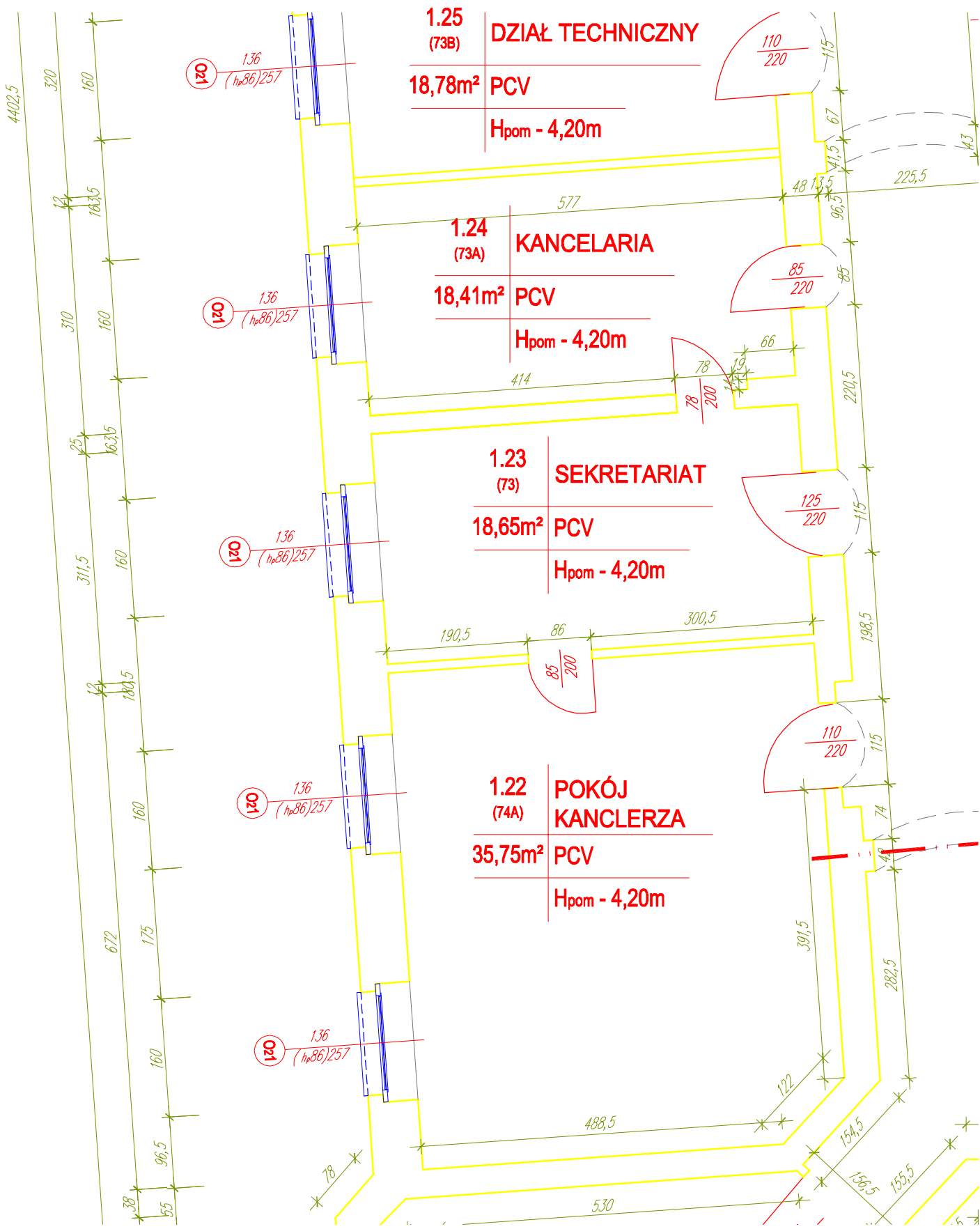

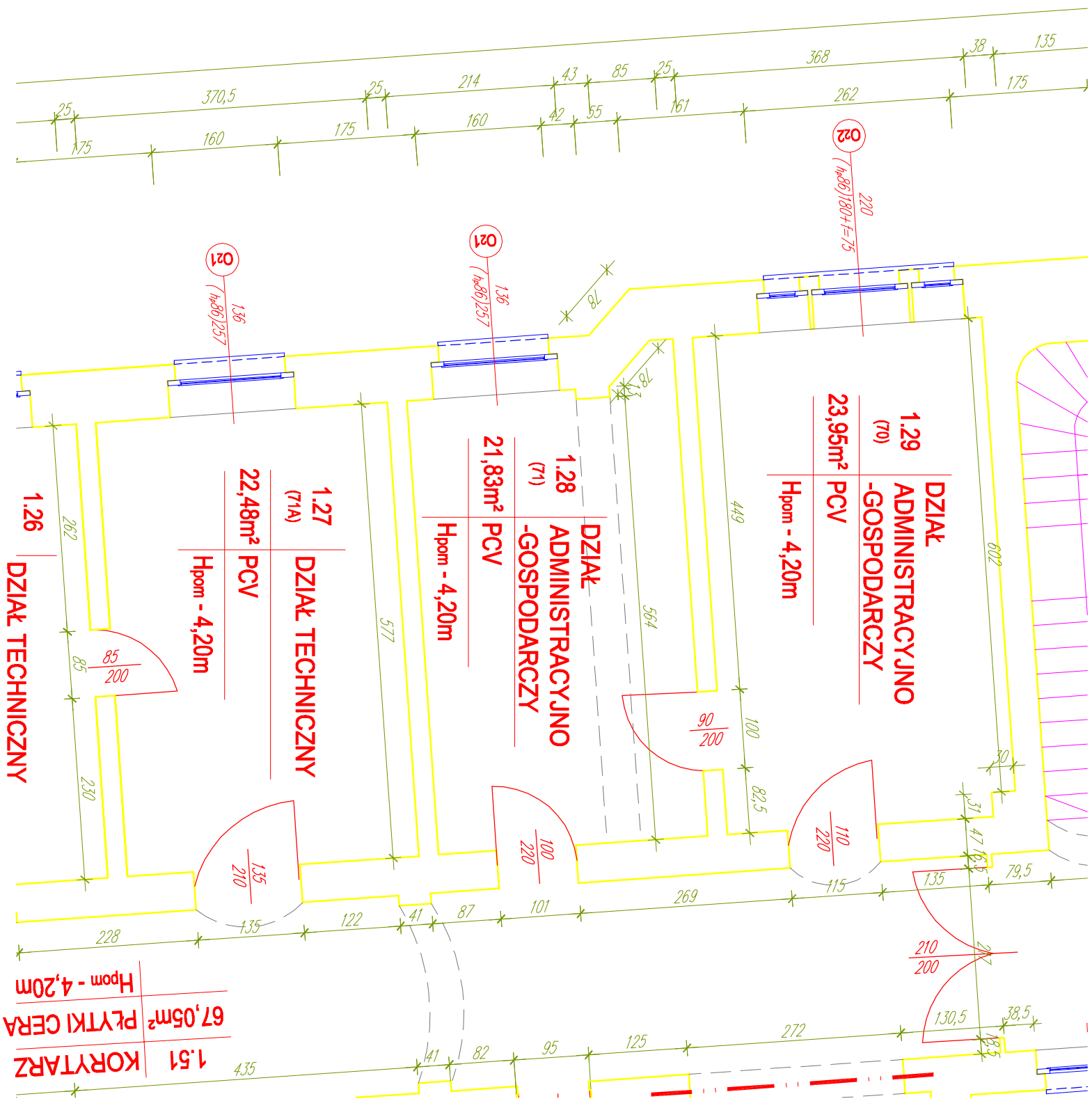

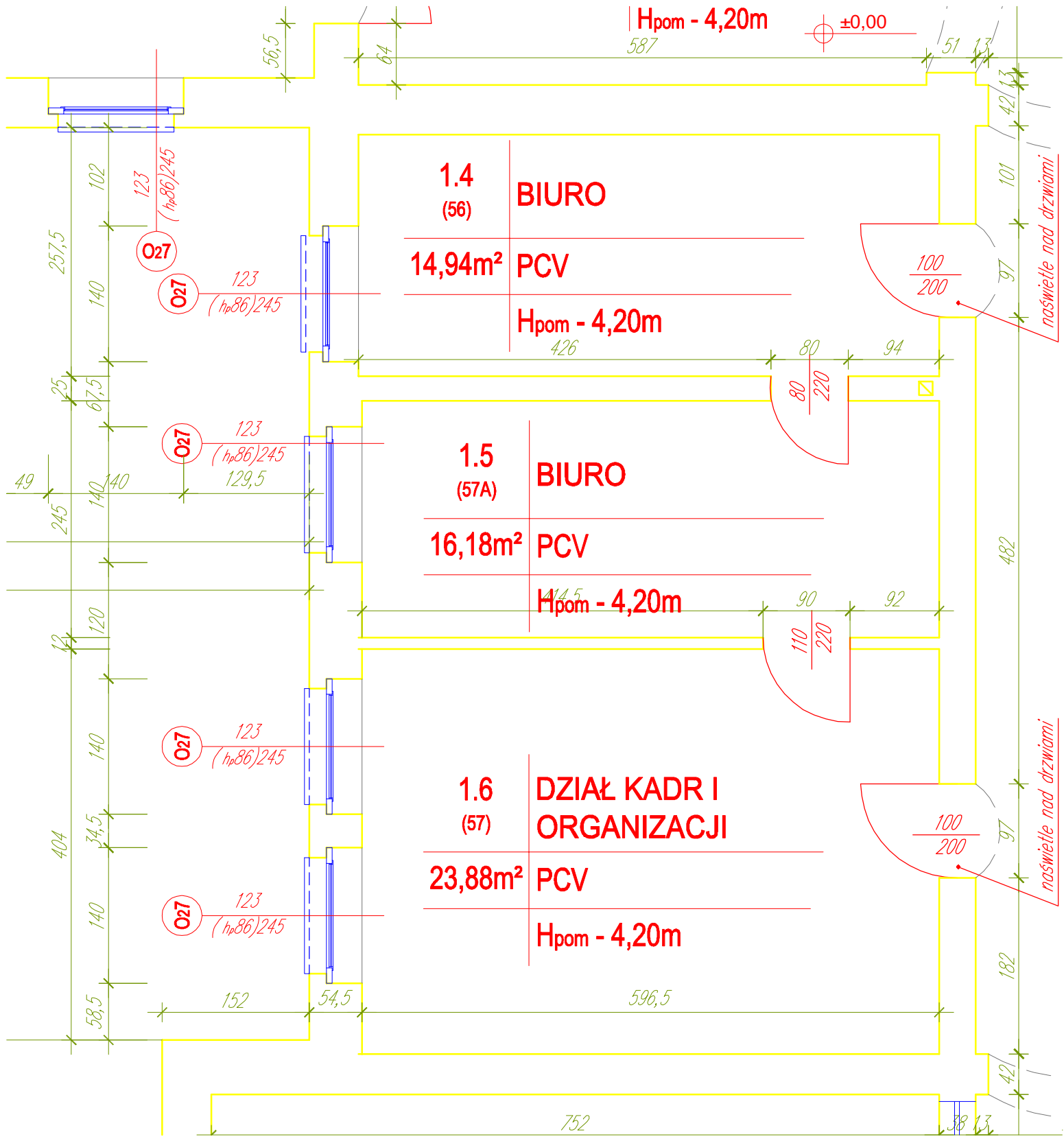

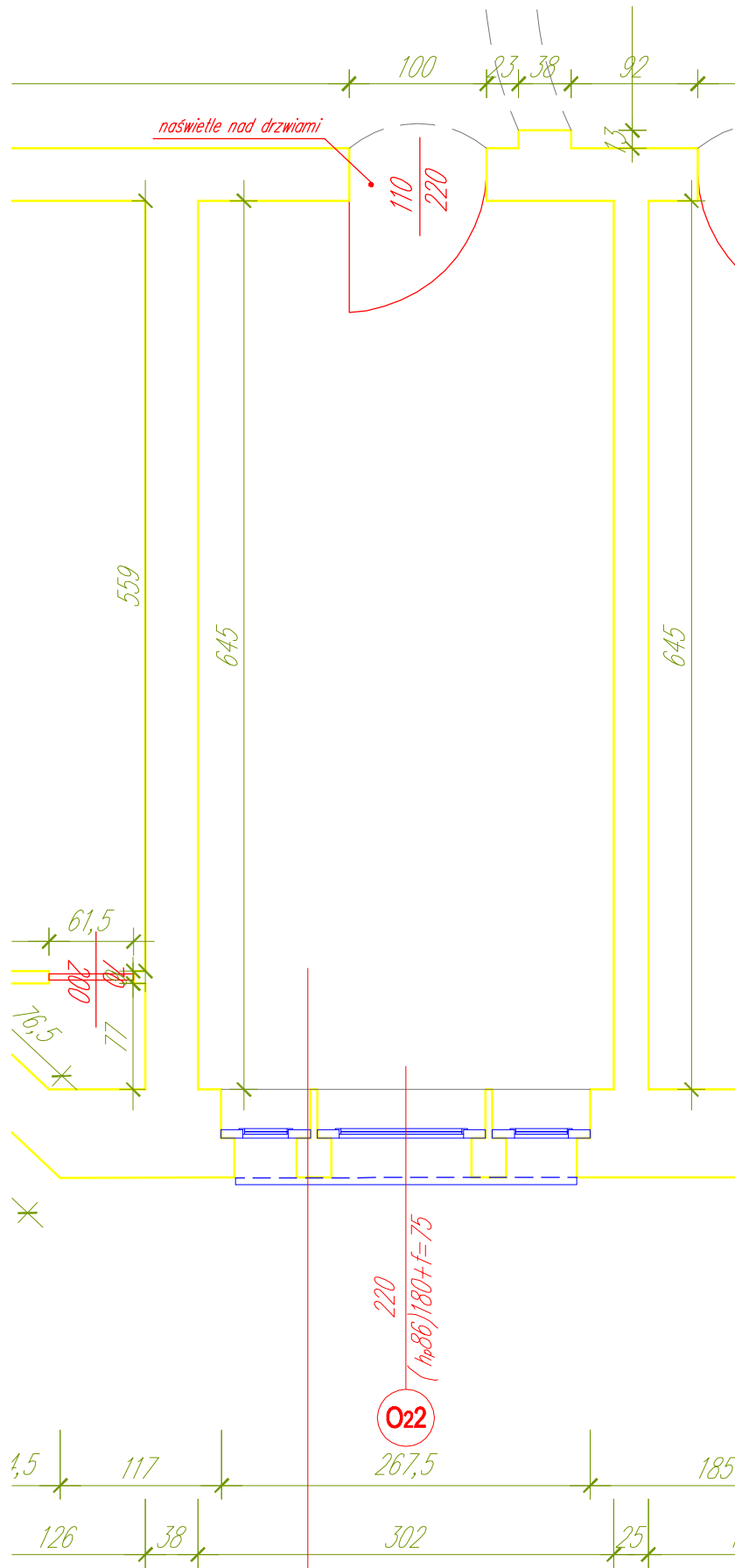

1.9
(6)

DZIAŁ PRAWNO-ORGANIZACYJNY

19,48m² PCV

H_{pom} - 4,20m